

TIMEDOT

SWISS+one

Instructions



EN

Thank you for purchasing swisstone TIMEDOT for the Amazon Echo Dot (2. Gen.). It combines with the Echo Dot (2. Gen.) to make the perfect smart alarm clock, adding an LED clock face, stylish fabric grill and improved speakers so you can wake up easily.

Use Alexa to set alarms, listen to music, read the morning headlines and more.

1. Overview

- 1. Brightness/Set:**
Press to change brightness.
Press and hold for two seconds to set the clock .
- 2. Upwards clock adjustment for hours/ minutes**
- 3. Downwards clock adjustment for hours/minutes**
- 4. USB Charging Port**
- 5. Power adaptor input socket**
- 6. Micro USB-connector for Echo Dot (2. Gen.)**
- 7. 3.5mm stereo jack connector for Echo Dot (2. Gen.)**

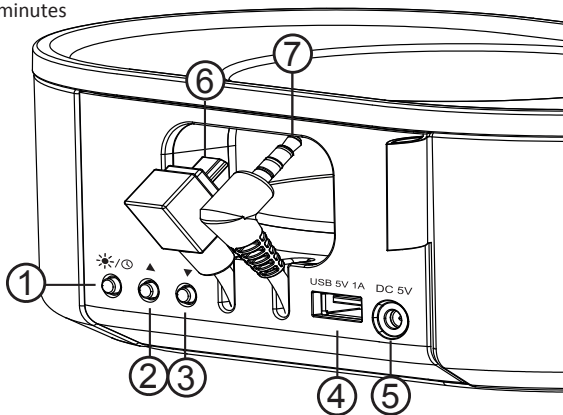

2. Insert your Echo Dot (2. Gen.) (not supplied)

Make sure that the sockets on your Echo Dot (2. Gen.) are lined up with the cable entry points on your speaker. Also make sure to not damage the cables when you insert the Echo Dot (2. Gen.).

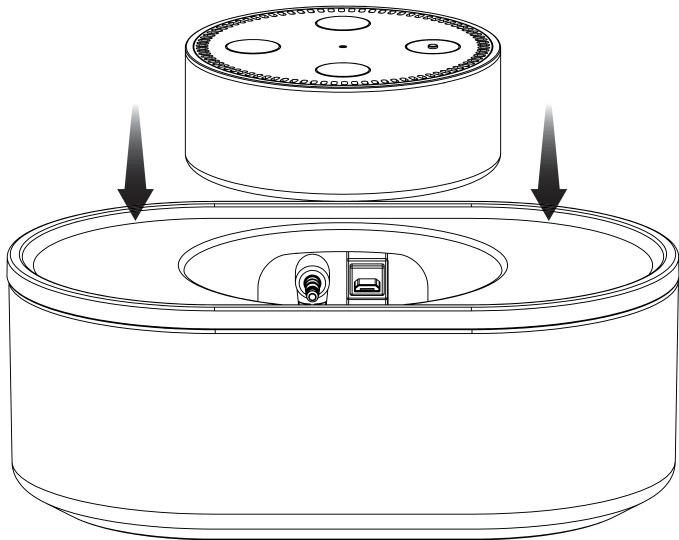

3. Connect both cables

These cables will connect your Echo Dot (2. Gen.) with the power and to the built-in speakers.

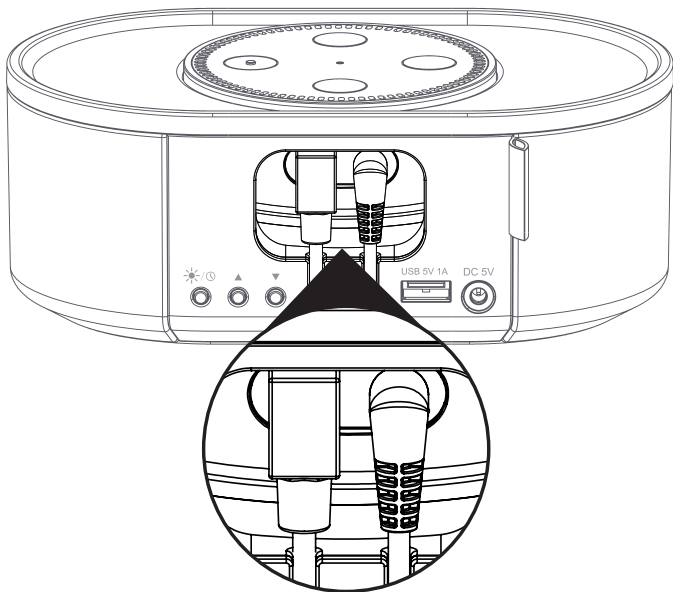

4. Power up

Connect the supplied power adaptor to the input socket (DC 5V) on the rear of the unit.

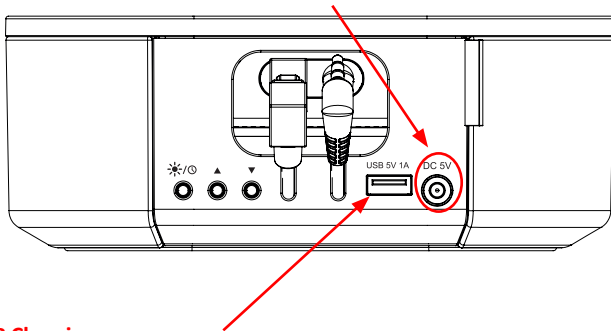

5. USB Charging

Use the USB 5V 1A port for charging smartphones and other portable devices.



6. Set the clock

1. Press and hold the 'set' button ☀️/🕒 for 2 seconds. The clock LEDs will flash.
2. Adjust the hour using the up/down buttons ▲/▼.
3. Press the 'set' button ☀️/🕒. The minute LEDs will flash.
4. Adjust the hour using the up/down buttons ▲/▼.
5. Press the 'set' button. The clock LEDs will stop flashing.

7. Adjust the LED brightness

Press the 'brightness' button ☀️/🕒 to cycle through the clocks brightness modes.

8. Set up or stop Timer & Alarm

To adjust the volume for alarm clock and timer, go to **Devices** (bottom right) in the Alexa app.

Select your Echo Dot (Echo and Alexa) ➔ **Sound** ➔ **Alarm, timer and notifications** (slider). To learn how to select a new sound for an alarm clock, go to **Customs sounds** ➔ **Alarm**.

Use voice control to set multiple timers and alarms. You can also set repeated alarms.

"Wake me up at 6 in the morning."

"Set the alarm clock to 7:30 clock."

"Set the timer to 10 minutes."

"When is my alarm clock set?"

"Set the alarm clock for [time / day]."

"What alarm clocks are set for tomorrow?"

"Which timers are set?"

"Stop" (when the alarm or timer sounds)

"Napping" (when the alarm sounds)

"End the timer for 10 minutes." (If you have set several timers)

9. Alexa - More things to try

Music:

"Alexa, play some Prime Music. Alexa, shuffle my mellow playlist. Alexa, play my Classic Jazz station"

"Alexa, what song is this?"

"Alexa, buy this song"

Shows, Podcasts & Radio

"Alexa, play the program In Our Time"

"Alexa, play BBC 1 radio"

Shop Amazon

"Alexa, order bin bags"

"Alexa, buy more kitchen towels"

Questions & Answers

"Alexa, what Italian restaurants are near me"

"Alexa, tell me a joke"

"Alexa, Wikipedia Winston Churchill"

News, Weather & Traffic

"Alexa, what is the latest news?"

"Alexa, what's the weather forecast?"

Smart Home

"Control supported smart home devices like swisstone SH 310 lights. To get started, go to the Alexa App"

"Alexa, dim lights to 50%"

"Alexa, turn on the fan"

Use These Anytime

"Alexa, stop"

"Alexa, volume five. (1-10)"

10. Other information

WARNING

The unit and the accessories can contain small parts. Keep all of the equipment out of the reach of small children. The mains adapter is the disconnect device between the product and mains power. The mains socket outlet must be close to the equipment and easily accessible.

Protect your hearing

WARNING

Excessive exposure to loud sounds can cause hearing damage. Exposure to loud sounds while driving may distract your attention and cause an accident. Do not hold the device near your ear when the loudspeaker is in use.

Care and maintenance

Your unit is a technically advanced product and should be treated with the greatest care. Negligence may void the warranty.

- Protect the unit from moisture. Rain/snowfall, moisture and all types of liquid can contain substances that corrode the electronic circuits. If the unit gets wet, you should remove the power and allow the unit to dry completely before you replace it.
- Do not use or keep the unit in dusty, dirty environments. The unit's moving parts and electronic components can be damaged.
- Do not keep the unit in warm places. High temperatures can reduce the lifespan for electronic equipment, damage batteries and distort or melt certain plastics.
- Do not keep the unit in cold places. When the unit warms up to normal temperature, condensation can form on the inside which can damage the electronic circuits.
- Do not drop the unit. Do not knock or shake it either. If it is treated roughly the circuits and precision mechanics can be broken.
- Do not use strong chemicals to clean the unit.

The advice above applies to the unit and other accessories. If the unit is not working as it should, please contact the place of purchase for service. Don't forget the receipt or a copy of the invoice.

Correct disposal of this product



(Waste Electrical & Electronic Equipment)



(Applicable in countries with separate collection systems)

This marking on the product, accessories or manual indicates that the product and its electronic accessories (e.g. charger, headset, USB cable) should not be disposed of with other household waste. To prevent possible harm to the environment or human health from uncontrolled waste disposal, please separate these items from other types of waste and recycle them responsibly to promote the sustainable reuse of material resources.

Household users should contact either the retailer where they purchased this product, or their local government office, for details of where and how they can take these items for environmentally safe recycling. Business users should contact their supplier and check the terms and conditions of the purchase contract. This product and its electronic accessories should not be mixed with other commercial wastes for disposal. This product is RoHS compliant.

Declaration of Conformity



We hereby declare that the radio equipment type swisstone TIMEDOT is in compliance with Directives:

2014/53/EU and 2011/65/EC (RoHS).

A copy of the Declaration of Conformity is available at www.swisstone.de.

Warranty

In case you need support during setup or usage of your product you will find the relevant contact details on the following website:
www.swisstone.de.

If you detect a defect resulting from manufacturing and/or material faults within 24 months from purchase, please contact your dealer. The warranty does not apply for improper treatment or failure to comply with information contained in this user guide, for interference on device executed by dealer or user (e. g. installations, software downloads,...) and for total loss. Furthermore it does not apply to ingress of liquids, use of force, non-maintenance, improper operation or other circumstances caused by the user. It also does not apply to failure caused by a thunderstorm or any other voltage fluctuations. The manufacturer reserves the right in this case to charge the customer for replacement or repair. For wear parts such as batteries or casing a restricted warranty period of 6 months is valid. Manuals and possibly supplied software are excluded from this warranty. Further or other claims arising from the manufacturer's warranty are excluded. Thus, there is no liability claim for business interruption, loss of profits, loss of data, additionally installed software by user or other information. The receipt with purchase date forms the warranty proof.

Technical Specifications

Power input (micro USB port):	5V 3A
Power output (USB port):	5V 1A
Speaker Power:	6 Watt RMS
Dimensions	Length: 17.8 cm
	Width: 11 cm
	Height: 6.8 cm
Weight	530 g

Changes and errors excepted.

© IVS GmbH 2018 • All rights reserved

Manual_TIMEDOT_en_110x110_v13

