



Instructions DOTBOX 1

ENGLISH



ENG

INSIDE PACKAGE

Thank you for purchasing swisstone DOTBOX 1 for the Amazon Echo Dot.

We recommend you take some time and read this instruction manual in order to fully understand all of its operational features. Please read the safety instructions carefully before using DOTBOX 1 for Echo dot and keep this manual for future reference.

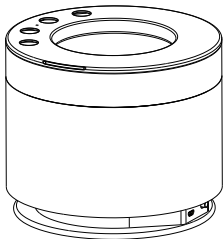

DOTBOX 1

DOTBOX 1 for Echo Dot is an excellent portable bluetooth speaker with multiple capabilities.

It will deliver full rich 360 degree sound from its compact design and the high capacity battery can support up to 8 hours of wireless play time.

It can also be used as an advanced Amazon Echo Dot speaker or as bluetooth speaker.



Instruction Manual



Micro USB charging cable

MAIN PARTS

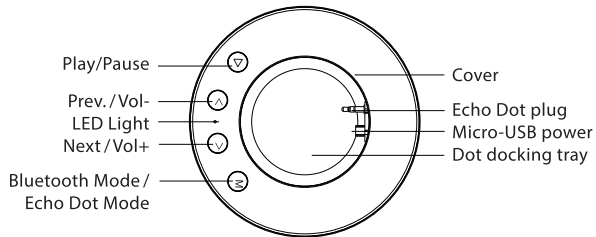
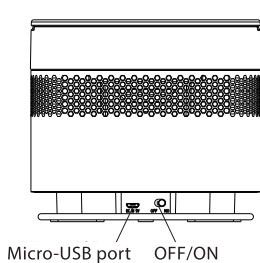

GENERAL OPERATION – Connecting your DOTBOX 1

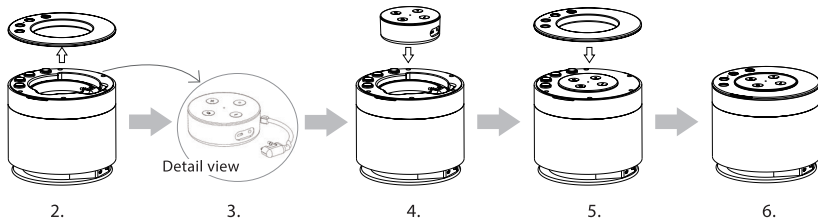

1. Ensure that your DOTBOX 1 is OFF
2. Remove cover from DOTBOX 1
3. Connect the combi plug of the DOTBOX 1 with the Micro-USB and sound connection of the Amazon Echo Dot
4. Place your Echo Dot into DOTBOX 1 in the docking tray

5. Replace the top cover (Please be careful not to squeeze cables around the edges, and pay attention to optimal fit of the recesses to the controls)
6. Power ON the DOTBOX 1

Now grab your favorite beverage and enjoy playing music on DOTBOX 1 via Alexa voice command or via your blue-tooth device

Connecting your DOTBOX 1 – **GENERAL OPERATION**



----- **Under Bluetooth mode, short press for previous track/long press to reduce Volume**



----- **Under Bluetooth Mode, short press to play/pause**

🔊 Long press until hearing the Beep to disconnect the pairing device and enter searching mode/ready for Line-in connection.



----- **Under Bluetooth Mode, short press for next track/long press to increase volume**

🔊 until hearing the Beep to maximum volume



----- **Press shortly to Echo Dot mode/Bluetooth mode**

Bluetooth mode has blue blinking light. Light stops blinking when connected to your device. The white light indicates you are in the Echo Dot mode.

GENERAL OPERATION – Indicating lights



Blue Light Blinks



Searching for Bluetooth device



Solid blue light



Bluetooth connected



The red light flashes slowly and gives a hint



Low battery



Solid white light



Echo Dot mode



Solid green light



Charge status



The green light goes dark and then goes out



Full of electricity

TECHNICAL SPECIFICATIONS

Bluetooth Pairing Name	DOTBOX_1
Charging Input	max. 5V/2A/DC (Recommended to use usual Amazon Echo Dot speaker power supply and cable)
Rechargeable battery type	Lithium battery, 2x 2600 mAh
Power Output	15 W
Inputs	Micro-USB
Bluetooth Version	4.2 + EDR (2.4) [10]
Working Distance of Bluetooth	10 meters
Weight	970g
Material	ABS + Fabric
Operating ambient temperature	Min: 0°C (32°F) Max: 40°C (104°F)

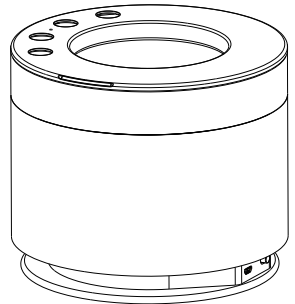

SAFETY INSTRUCTIONS



WARNING

The unit and the accessories can contain small parts. Keep all of the equipment out of the reach of small children.

The mains adapter is the disconnect device between the product and mains power. The mains socket outlet must be close to the equipment and easily accessible.

AREAS WITH EXPLOSION RISK

Always turn off the unit when you are in an area where there is a risk of explosion. Follow all signs and instructions. There is a risk of explosion in places that include areas where you are normally requested to turn off your car engine. In these areas, sparks can cause explosion or fire which can lead to personal injury or even death.

Turn off the unit at filling stations, and any other place that has fuel pumps and auto repair facilities.

Follow the restrictions that apply to the use of radio equipment near places where fuel is stored and sold, chemical factories and places where blasting is in progress. Areas with risk for explosion are often

– but not always – clearly marked. This also applies to below decks on ships; the transport or storage of chemicals; vehicles that use liquid fuel (such as propane or butane); areas where the air contains chemicals or particles, such as grain, dust or metal powder.

LI-ION BATTERY

This product contains a Li-ion battery. There is a risk of fire and burns if the battery pack is handled improperly.

SAFETY INSTRUCTIONS

WARNING

Danger of explosion if battery is incorrectly replaced. To reduce risk of fire or burns, do not disassemble, crush, puncture, short external contacts, expose to temperature above 60° C (140° F), or dispose of in fire or water. Recycle or dispose of used batteries according to the local regulations or reference guide supplied with your product.

PROTECT YOUR HEARING

WARNING

Excessive exposure to loud sounds can cause hearing damage.
Exposure to loud sounds while driving may distract your attention and cause an accident.
Do not hold the device near your ear when the loudspeaker is in use.

WHEN YOU FLY

It is prohibited to use the unit in flight. Turn off the unit before you board a plane. Using wireless Bluetooth units inside a plane can pose risks to air safety and interfere with telecommunications. It may also be illegal.

CLEAN THE UNIT

- Clean the surface with a soft, dry cloth.
- Do not use any sprays near the unit. Do not use any solvents, chemicals, or cleaning solutions containing alcohol, ammonia or abrasives.
- Do not allow liquids to spill into any openings.

SAFETY INSTRUCTIONS

CARE AND MAINTENANCE

Your unit is a technically advanced product and should be treated with the greatest care. Negligence may void the warranty.

- Do not use or keep the unit in dusty, dirty environments. The unit's moving parts and electronic components can be damaged.
- Do not keep the unit in warm places. High temperatures can reduce the lifespan for electronic equipment, damage batteries and distort or melt certain plastics.
- Do not keep the unit in cold places. When the unit warms up to normal temperature, condensation can form on the inside which can damage the electronic circuits.
- Do not drop the unit. Do not knock or shake it either. If it is treated roughly the circuits and precision mechanics can be broken.
- Do not use strong chemicals to clean the unit.

The advice above applies to the unit, battery and other accessories. If the unit is not working as it should, please contact the place of purchase for service. Don't forget the receipt or a copy of the invoice.

Bluetooth® and the Bluetooth® logo are registered trademarks of Bluetooth SIG, Inc.

DECLARATION OF CONFORMITY

We hereby declare that swisstone DOTBOX 1 is conform to the essential requirements and other relevant regulations contained in the Directives 2014/53/EU and 2011/65/EC (RoHS). A copy of the Declaration of Conformity is available at www.swisstone.de.

SAFETY INSTRUCTIONS

WARRANTY

In case you need support during setup or usage of your unit you will find the relevant contact details on the following website:

www.swisstone.com.

If you detect a defect resulting from manufacturing and/or material faults within 24 months from purchase, please contact your dealer. The warranty does not apply for improper treatment or failure to comply with information contained in this user guide, for interference on device executed by dealer or user (e. g. installations, software downloads,...) and for total loss. Furthermore it does not apply to ingress of liquids, use of force, non-maintenance, improper operation or other circumstances caused by the user. It also does not apply to failure caused by a thunderstorm or any other voltage fluctuations. The manufacturer reserves the right in this case to charge the customer for replacement or repair. For wear parts such as batteries or casing a restricted warranty period of 6 months is valid. Manuals and possibly supplied software are excluded from this warranty. Further or other claims arising from the manufacturer's warranty are excluded. Thus, there is no liability claim for business interruption, loss of profits, loss of data, additionally installed software by user or other information. The receipt with purchase date forms the warranty proof.

SWISS+one

Changes and errors excepted.
© IVS GmbH 2018 • All rights reserved

